

Case Study – Development



Project: Old York Business Park, Bordentown Township, NJ
Product: Premier 8
Manufacturer: Beavertown Block Company
Design: French & Parrello Associates
Contractor: Site Ready Construction
Total Area: 16,950 sq. ft.
Wall Heights: 24 ft. vertical

Design Challenge:

The project called for construction for 2 of the 8 walls to support a heavy-load access road over parts of large stormwater system.

Design Solution:

The developer chose Rockwood's Premier® 8 block for its proven strength, design versatility, lightweight advantages and economic solution.

The Result:

During periods of heavy rain, the 54 lb. unit weight reduced installer fatigue helping to cut construction time significantly. Fewer freight loads reduced offloading and staging time.



Premier™ 8

Premier 8, Rockwood's unique and patented block design is changing the SRW industry. Its 54 lb. unit weight beats all other block systems for strength, performance, freight efficiencies and ease of construction. Premier 8's gravel filled cores create vertical "stone columns" to create a multi-point interlock for a more uniform block-to-grid connection, the result is one of the strongest block-to-grid connections in the SRW industry.

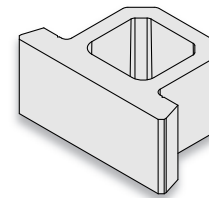

- Straight Split
- 18" W x 12" D x 8" H (45cm x 30cm x 20cm)
- 54 lbs., 24.5 kg

Appearance
Dependability
Efficiency

ROCKWOOD®
RETAINING WALLS
A better way.™